

Operating pressure max.
Max. temperature range
Applications

60 bar
150 °C
Pneumatic, oil hydraulic and hydraulic circuits

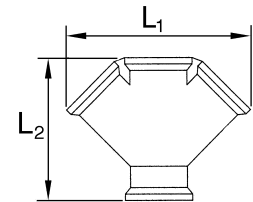

255.012

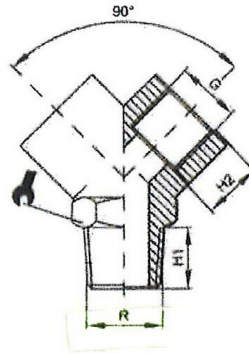

255.212

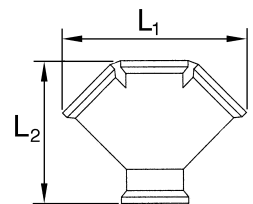
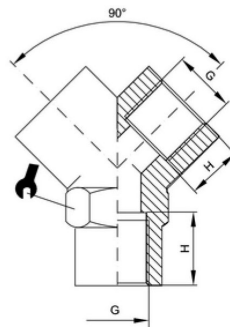
Distributor, 2 outlets, nickel-plated brass

Art. No.	Type No.	Thread	Outlet	L1 mm	L2 mm	H mm	H1 mm	H2 mm	a/f mm
112596	255.00	R 1/8 ET	2 x G 1/8 IT	29.0	32.0	8.0	-	-	13
112597	255.00/1	R 1/4 ET	2 x G 1/4 IT	36.0	38.0	11.0	-	-	17
112598	255.038	R 3/8 ET	2 x G 3/8 IT	41.0	42.5	-	11.5	11.5	20
112599	255.012	R 1/2 ET	2 x G 1/2 IT	53.0	53.0	-	14.0	14.0	25
112600	255.218	G 1/8 IT	2 x G 1/8 IT	29.0	26.5	8.0	-	-	13
112601	255.214	G 1/4 IT	2 x G 1/4 IT	36.0	32.0	11.0	-	-	17
112602	255.238	G 3/8 IT	2 x G 3/8 IT	41.0	37.0	11.5	-	-	20
112603	255.212	G 1/2 IT	2 x G 1/2 IT	53.0	45.0	14.0	-	-	25